

**SYNKO-FLEX WATERSTOP, MIRASTOP BW, OR MIRASTOP NBW**  
 (SEE NOTE #2)

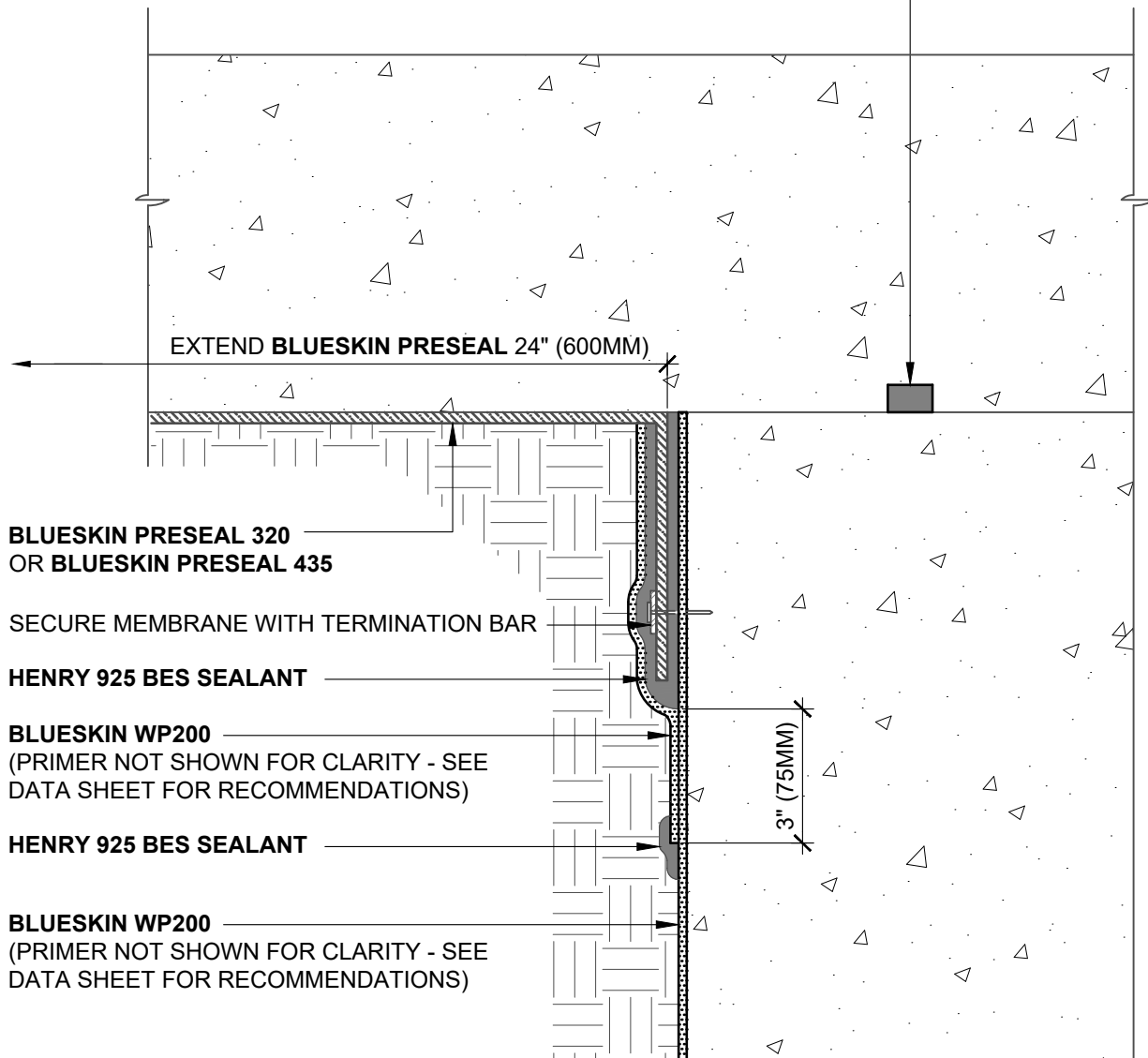

**BLUESKIN PRESEAL 320**  
 OR **BLUESKIN PRESEAL 435**

SECURE MEMBRANE WITH TERMINATION BAR

**HENRY 925 BES SEALANT**

**BLUESKIN WP200**  
 (PRIMER NOT SHOWN FOR CLARITY - SEE  
 DATA SHEET FOR RECOMMENDATIONS)

**HENRY 925 BES SEALANT**

**BLUESKIN WP200**  
 (PRIMER NOT SHOWN FOR CLARITY - SEE  
 DATA SHEET FOR RECOMMENDATIONS)

**NOTES:**

1. DETAIL SHOWS HENRY PRE-APPLIED WATERPROOFING SYSTEM FOR APPLICATIONS USING HENRY **BLUESKIN PRESEAL 320** OR **BLUESKIN PRESEAL 435**. SUBSTRATE SHOWN IS FOR REFERENCE ONLY.
2. APPLICATIONS USING SWEALLABLE WATERSTOPS: 3" (75MM) MINIMUM CONCRETE COVERAGE ON ALL SIDES.
3. HENRY RECOMMENDS THE USE OF A DRAINBOARD IN NON-HYDROSTATIC CONDITIONS, OR AS A SUBSTRATE PREPARATION.
4. REFER TO PRODUCT SPECIFIC TECHNICAL DATA SHEET (TDS) AND GUIDE SPECIFICATION FOR INSTALLATION PROCEDURES.

MANUFACTURER GUIDE DETAILS ARE FOR REFERENCE ONLY. HENRY DOES NOT ASSUME RESPONSIBILITY FOR ERRORS OR DEVIATIONS IN DESIGN OR ENGINEERING. PROJECT SPECIFIC VERIFICATION IS RECOMMENDED PRIOR TO INSTALLATION.

**HENRY PRE-APPLIED WATERPROOFING SYSTEM**

**ELEVATED SLAB**

**BLUESKIN PRESEAL 320 OR BLUESKIN PRESEAL 435**  
**TIE-IN TO BLUESKIN WP200 AT FOOTING/GRADE BEAM**

SCALE: N.T.S.

09-14-2022

**BSPS-1E1**

